

STANDARD REGISTER INSTALLATION GUIDE

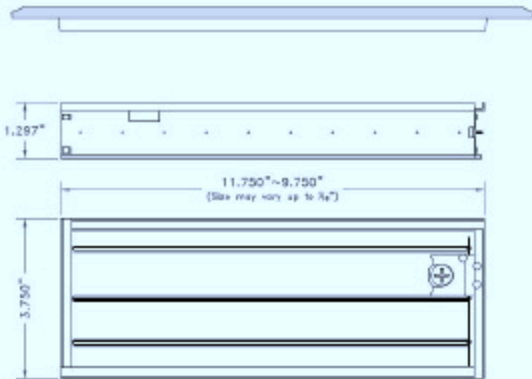

Louver Adjustment Instructions:

By using a wide flange (standard) Philips Screwdriver (as shown) the louver can be either opened or closed. Confirm with contractor or HVAC Inspector/Installer on recommendations for which louvers should remain open and which can be closed. Depending on season and location this can change.

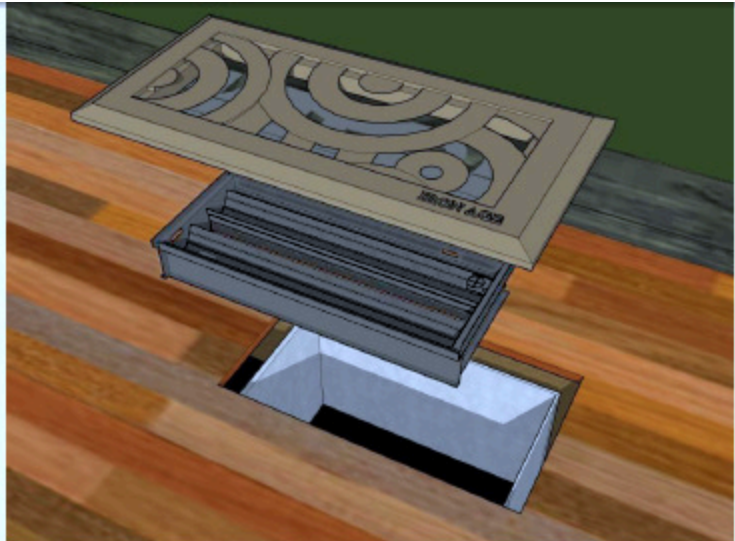
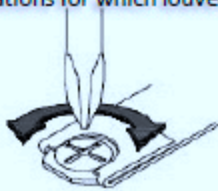

Installation Instructions:

- Slip louver into HVAC Register Boot. The Louver sits within the actual vent.
- Secure with self-tapping sheet metal screws or other (In a new construction, refer to HVAC contractor for suggestions)
- Seal with Thermal Batting per Home center/contractor Recommendation.
- Fit Register over Louver, it should fit so that the opposed blade damper adjuster is visible from directly above. (Check this before Installation based on homeowner/contractor's discretion.)

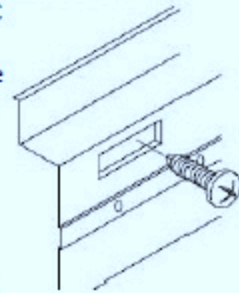

****Optional - Register can be drilled and secured to wall/ceiling in vertical or above installations. (Or public area at the contractor/homeowner's discretion.)**